

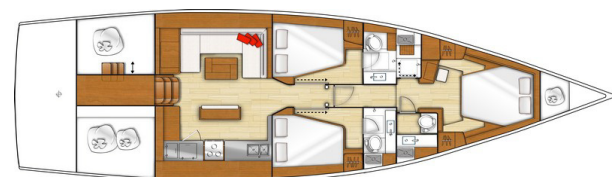

Hard top

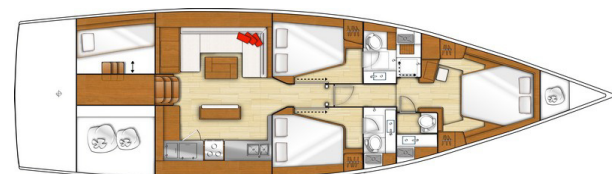

3 cabins - 3 heads



3 cabins - 3 heads - 1 Occasional cabin (option)

## GENERAL SPECIFICATIONS

• L.O.A:		
- with bowsprit	17,78 m	58'4"
- without bowsprit	17,31 m	56'9"
• Hull length	16,80 m	55'1"
• L.W.L.	15,93 m	52'3"
• Beam	4,97 m	16'4"
• Deep draft	2,40 m	7'10"
• Deep ballast weight	4 900 kg	10,803 lbs
• Shallow draft	1,85 m	6'1"
• Shallow ballast weight	5 500 kg	12,125 lbs
• Air draft	23,91 m	78'5"
• Light displacement (EC)	17 910 kg	39,474 lbs
• Fuel capacity (standard)	415 L	110 US Gal
• Fuel capacity (Option)	415 L	110 US Gal
• Fresh water capacity (standard)	640 L	169 US Gal
• Fresh water capacity (Option)	330 L	87 US Gal
• Engine power	80 HP	80 HP
	110 HP	110 HP

## ARCHITECTS / DESIGNERS

- Naval Architect : Berret Racoupeau Yacht Design
- Interior design : Nauta Design

## CE CERTIFICATION

- Category A - 10 people
- Category B - 11 people
- Category C - 16 people

## STANDARD SAILS DIMENSIONS

• Mainsail	72 m <sup>2</sup>	775 sq/ft
• Furling mainsail	69 m <sup>2</sup>	743 sq/ft
• Genoa (105 %)	73 m <sup>2</sup>	785 sq/ft
• Asymmetrical spinnaker	200 m <sup>2</sup>	2,152 sq/ft
• Code 0	115 m <sup>2</sup>	1,238 sq/ft
• Self-tacking jib	59 m <sup>2</sup>	635 sq/ft
• Staysail	34 m <sup>2</sup>	366 sq/ft
• I	20,97 m	68'10"
• J	7,31 m	24'
• P	20,2 m	66'3"
• E	6,35 m	20'10"



## STANDARD EQUIPMENT

### CONSTRUCTION

- Design in accordance with European Directive requirements and according to CE certification
- Monolithic hull design in polyester
- Monolithic structural counter moulding laminated and bonded to the hull
- Deck in balsa and fiberglass sandwich covered in "diamond point" type non-slip surface
- Hull/deck joint screwed, bonded and covered with a single solid wood rubbing strake screwed in place
- Cast iron keel bonded and bolted using stainless steel bolts and counter plate
- Twin underhung rudders with stainless steel stock
- White coloured hull - Grey metallic livery

### DECK EQUIPMENT

#### RIGGING

- Standard mast SELDEN 9/10 anodized aluminium deck stepped, 2 aft-swept spreaders - MDS roller slides
- Anodised aluminium boom
- Discontinuous stainless steel standing rigging
- Backstay: Bridle
- Rigid boom vang with tackle
- Genoa furling system with drum on the deck
- 2 "STANDUP" blocks for mainsail on fixed composite arch
- 2 Genoa tracks with piston adjusted traveller cars - 2 Genoa sheet turning blocks
- Rigging run back to cockpit (except boom topping lift)
- Complete running rigging: Main halyard, genoa halyard with clutch on mast and cleat, Boom topping lift with cleat on mast, Mainsheet, 2 Genoa sheets 2 rapid reefing lines, 1 manual reef
- 12 Clutches, and other control lines
- 2 rope boxes

#### WINCHES

- 2 Self-tailing genoa sheet winches (H60.2 STC)
- 2 Self tailing coachroof winches (H46.2 STC to starboard, H50.2 STC to port)
- 2 Winch handles SpeedGrip
- 2 Winch handle boxes

#### SAILS

- Dacron furling genoa, double thickness with UV protection strip
- Full batten dacron mainsail with Beneteau logo
- Lazy Jack and Lazy Bag in Natural colour

#### MOORING LINES - MOORING

- Self-draining chain locker
- Stainless steel bow fitting 2 rollers - Stainless steel bobstay
- 12 V - 1500 W vertical electrical windlass - Remote control
- 8 Aluminium mooring cleats - Stainless steel chafine plate

#### SAIL LOCKER

- Access through deck hatch
- Stainless steel ladder
- Hatch giving access to chain locker

## SAFETY ON DECK

- 1 Open stainless steel pulpit
- 2 fixed stainless steel pushpits
- 1 Lifebuoys support bracket
- 1 Outboard engine bracket
- 1 Ensign staff
- Double guard lines and stainless steel stanchions - Side boarding gate on either side
- 2 Stainless steel handrails on deck
- 2 Stainless steel handrails on fixed arch

## COCKPIT

- Self-draining cockpit, natural solid wood decked
- 1 Port cockpit locker - Access to technical area or Occasional cabin (option)
- 1 Starboard cockpit locker - Access to technical area
- Gas locker beneath starboard cockpit seat
- Natural solid wood slatted cockpit benches
- 1 Liferaft locker in cockpit sole
- 2 Steering wheel consoles: Stainless steel steering wheels - 900 mm / 2'11" diameter - Leather covered - Stainless steel handrail - navigation instrument support (optional instruments) - Glass holder - 2 Steering compass on binacelle
- 2 Deck access points to tiller system
- 1 Tiller
- Engine throttle and control panel on starboard
- Wooden cockpit table with leaf to starboard which can be transformed into sun-bathing area
- 1 Fixed composite arch
- 2 waterproof loudspeakers on fixed arch
- Cockpit lighting integrated in fixed arch
- 1 PMMA companionway door
- 2 Fixed windows to the aft of the coachroof
- 1 Hot and cold cockpit shower
- 1 Shore power socket

## AFT TRANSOM

- Fully opening transom, convertible to bathing platform (3,20 m x 0,80 m / 12'6" x 2'7")
- Electrically operated
- Natural solid wood decking on swim platform
- 1 Folding bathing ladder (stainless steel), solid wood steps, handrails



## INTERIOR

- Alpi walnut woodwork
- Rovere Aleve type laminated floorboards
- Fabric hull linings in saloon and cabins (Beige)
- Fabric upholstery in the saloon
- Marine mattresses in the cabins

### COMPANIONWAY

Headroom: 1,99 m / 6'6"

- Wooden companionway with cold-moulded 3 steps
- 2 Leather covered stainless steel handrails

### PORT SALOON

Headroom: 1,98 m / 6'6"

- U shaped saloon bench
- Saloon table in 1 piece, Varnished wood top with inlay, Aluminium legs.
- 1 central unit with folding bench seat - Stowage - Bar
- Shelves and stowage along the hull, Storage under bench seats
- 1 Hull porthole with curtain
- 1 Fixed coachroof side window with pleated blind
- 1 Fixed wrap-around window to cockpit + Blind
- 1 Deck hatch with mosquito blind

### CHART TABLE

- Control console with flap - miscellaneous locker - Storage - Moulded wood fiddle
- Navigator's seat with (15°) tilting cushion to compensate for heel
- Electrics panel
- Navigation instrument panel (without instruments)
- Radio with stereo CD / MP3 player - 2 Loud speakers
- Battery switch panel + Breaker panel

### GALLEY - STARBOARD

Headroom: 1,97 m / 6'6"

- Lengthways galley counter
- Synthetic resin worktop Grey
- 1 Sink with 2 rectangular bowls, in Grey synthetic resin
- 1 Valve - Hot/cold water mixer tap
- 1 Gas cooker 2 burners, Stainless steel oven on gimbal
- 1 Fridge 200 L, ice-cube tray, front and top-opening
- 1 Cooler 100 L, top opening
- Cupboards - Drawers - equipped lockers
- 1 Hull porthole with curtain
- 1 Fixed coachroof side window with pleated blind
- 1 Fixed wrap-around window to cockpit + Blinds
- 1 Deck hatch with mosquito blind

### FORWARD CABIN

Headroom: 1,94 m / 6'4"

- Central double bed (2,03 m x 1,21 m - 1,70 m / 6'8" x 4' - 5'7") - Slatted bed base
- Wardrobe, Cupboard, Shoe cabinet
- Dressing table with grey top and removable seat
- Mirrors
- 2 Hull portholes with curtain
- 2 Opening deck hatches with mosquito blinds

## FORE HEAD

### Separate shower, to port

Headroom: 1,93 m / 6'4"

- Private access via glazed door
- Mirror - Cupboard
- Shower - Hot/cold water mixer tap
- 1 Deck hatch with mosquito blind

### Separate WC. To starboard

Headroom: 1,94 m / 6'4"

- Manual toilet + Holding tank (80 L / 21 US Gal)
- Washbasin - Synthetic resin worktop - Hot/cold water mixer tap
- Mirror
- Toilet accessories
- Cupboard - Cubby hole locker
- 1 Deck hatch with mosquito blind

## CABINS - PORT AND STARBOARD

Headroom: 1,97 m / 6'6"

2 Cabins each with:

- Sliding entrance door
- Double bed (2,00 m x 1,00 m - 1,56 m / 6'7" x 3'3" - 5'1") - Slatted bed base
- Hanging locker - Shelving unit - Drawers
- Mirror
- 1 Hull porthole with curtain
- 1 Opening deck hatch with mosquito blind

## HEADS - PORT AND STARBOARD

Headroom: 1,94 m / 6'4"

2 Each head containing:

- Private entrance through cabin
- Separate moulded shower, Hot/cold water mixer tap
- Manual toilet + Holding tank (80 L / 21 US Gal)
- Washbasin - Synthetic resin worktop - Hot/cold water mixer tap
- Mirror
- Toilet accessories
- Cupboard and cubby hole
- 1 Opening deck hatch with mosquito blind

**OCCASIONAL CABIN (OPTION)** - In place of the sail locker (Port side)

Headroom: 1,18 m / 3'10"

Access through the cockpit locker

- Solid wood sliding ladder
- Marine mattress
- 1 Opening porthole
- 1 Opening hatch

## ENGINE

- Engine Yanmar Diesel:
  - 80 HP / 80 HP Common Rail, Sail Drive (standard)
  - 80 HP / 80 HP Common Rail, Dock & Go (Option)
  - 110 HP/110 HP Propeller shaft, Common Rail (Option)
- Engine control - Starting - Control panel in cockpit
- Engine compartment: Foam soundproofing - Ventilation: 1 air intake and 1 pressured air outlet
- 1 Alternator 12 V / 125 Ah
- 1 Rotomoulded diesel tank (415 L / 110 US Gal in the saloon) - Electronic gauge - Low level alarm - 1 Deck filler
- Filters: Sea water - Diesel - Water separator
- Fixed three blades propeller
- Engine access via companionway and machinery space (opening with gas piston)

## ELECTRICITY

- 12 V circuit - 220 V circuit
- 2 service batteries (2x140 Ah) - 1 Engine battery (110 Ah)
- 1 40 Ah Battery charger - 1 220V shore power - 1 Power distributor
- Electrical panel (12 V / 220 V) (Circuit breakers - Voltmeter - Water gauge - Fuel gauge - Battery warning - Fuel warning)
- 220V Sockets
- Interior lighting: Halogen ceiling lights, Reading lights
- Outside lighting: 1 Forward and aft navigation lights - 1 Steaming light - 1 Anchor light on masthead - 1 Deck light
- Wire runs for option cables

## PLUMBING

- 3 Rotomoulded freshwater tanks (3 x 200 L / 3 x 53 US Gal) - Saloon / Side cabins - Separate fillers - Tank selection with "¼ turn" by-pass valves
- Pressurised electric water pump - Expansion tank - Inline filter
- 40 L / 11 US Gal Electric boiler (Operation off engine or on 220 V electrical system)
- 1 Rigid 80 L / 21 US Gal black water holding tank for each WC
- Electrical shower drain pumps
- 2 Electric bilge pumps - 1 Manual bilge pump
- 1 Electric pump for the ice box drain

## GAS

- Gas bottle box in the cockpit (1 or 2 bottles, according to model)
- Regulator and safety tap

## TRIM LEVEL

	ESSENTIAL	EXCLUSIVE
<ul style="list-style-type: none"> <li>• Bow nose with built-in mooring and bowsprit stay</li> <li>• Cockpit galley under helmsman seats (Sink - Gas plancha)</li> <li>• 1 Port electric primary winch (H50.2 STECH)</li> <li>• Releasable forestay chainplate</li> <li>• Stainless steel beading for fenders in cockpit locker</li> <li>• 4 Opening ports in galley and saloon windows</li> <li>• Hifi: Fusion + Interior loudspeakers &amp; Waterproof exterior speakers</li> <li>• Galley: Refrigeration system, 12 V, in 100 L top-opening icebox (for storage below 0°C)</li> <li>• 12/230 V, 2 kVA inverter</li> <li>• 2 USB sockets at the chart table to recharge mobile devices</li> <li>• 2 service batteries (2 x 140A, 12V) + Additional 40 ampères battery charger</li> <li>• AGM Batteries</li> <li>• Storage space(s) under the floor</li> <li>• LED interior lights</li> </ul>	<ul style="list-style-type: none"> <li>• ■</li> <li>• ■</li> <li>• ■</li> <li>• ■</li> <li>• ■</li> <li>• ■</li> <li>• ■</li> <li>• ■</li> <li>• ■</li> <li>• ■</li> <li>• ■</li> <li>• ■</li> <li>• ■</li> </ul>	<ul style="list-style-type: none"> <li>• ■</li> <li>• ■</li> <li>• ■</li> <li>• ■</li> <li>• ■</li> <li>• ■</li> <li>• ■</li> <li>• ■</li> <li>• ■</li> <li>• ■</li> <li>• ■</li> <li>• ■</li> <li>• ■</li> </ul>
<ul style="list-style-type: none"> <li>• Pump for deck washing</li> <li>• Textile storage on 2 steering consoles</li> <li>• Upgrade - Bose speakers in saloon</li> <li>• Galley: "Luxe" 3 burners hob, stainless steel oven and grill</li> <li>• 3 Electric toilet</li> <li>• LED: Outside lighting (except deck light)</li> <li>• LED interior lights (Indirect)</li> </ul>		<ul style="list-style-type: none"> <li>• ■</li> <li>• ■</li> <li>• ■</li> <li>• ■</li> <li>• ■</li> <li>• ■</li> <li>• ■</li> </ul>

## PACKS

### ELECTRONIC B&G PACK

#### A Pack

- Helm consoles to port and starboard:
  - 1 Triton 2 B&G display (Log, Speedometer, Depth sounder, Windvane anemometer)
  - 1 Multifunction touchscreen B&G Zeus 9" wide wireless (GPS, Chart plotter, Chart reader - Navionics Silver cartography included)
- PC interface

#### B Pack

- Multifunction touchscreen B&G Zeus 12" wide wireless, Chart table

#### Pilot pack

- NAC3 autopilot (with gyro compass), Control at steering station
- WR10 Wireless autopilot remote control

## VERSION

	DOCK & GO
<ul style="list-style-type: none"> <li>• Engine: YANMAR - Common Rail - Diesel</li> <li>• Swiveling Sail Drive base</li> <li>• Joystick</li> <li>• Vessel Management Unit (VMU)</li> <li>• Bow thruster</li> <li>• Auto pilot</li> </ul>	<ul style="list-style-type: none"> <li>• ■</li> <li>• ■</li> <li>• ■</li> <li>• ■</li> <li>• ■</li> <li>• ■</li> </ul>

## OTHER OPTIONS

### NAVIGATION ELECTRONICS: B&G

- 4G Radar
- AIS 500 (Transmitter / Receiver)
- Port cockpit: B&G H50 VHF, function AIS receiver + H50 cockpit handset
- Chart table: Fixed B&G V90 VHF, function AIS receiver
- Forward Scan Sensor (Forward underwater vision)

### RIGGING - SAIL

- Anodised furling mast with mylar Taffetas main and genoa
- In-boom furling
- Grey lacquered canoe boom
- Asymmetrical spinnaker rigging + Code 0 rigging
- Self-tacking jib hardware
- Hydranet sail for classic mast (in lieu of standard)
- Hydranet self-tacking jib (replacing genoa)
- Hydranet self-tacking staysail with manual furling + Fixed forestay
- Laminated Mylar Taffetas code 0 with furling drum
- Asymmetrical spinnaker
- Releasable forestay chainplate
- Hydraulic backstay\*
- Genoa sheet track leads adjustable from the cockpit
- Flag halyards

\* Except on mast with in-mast furling

### WINCHES

- Electric genoa sheet winches H60.2STCEH
- Starboard electric coachroof winch H46.2STCEH
- Rewind rope handling winch

### HULL - DECK - COCKPIT

- Blue-grey hull - Pearl white livery
- Grey "Perle" hull - Matte black hull decoration
- Metallic hull paint
- Slatted solid wood side decks
- Starboard wood cockpit table with electrical up/down system
- Wood cockpit table port side, plate and removable seat + Protective cover, Cadet Grey
- White PVC steering wheels and console covers
- Rigid bimini with foldable Cadet Grey canvas
- Luxe bimini, Cadet Grey
- Complete Luxe cockpit closing, Cadet Grey
- Luxe coachroof sprayhood, Cadet Grey
- Covers pack Luxe (Table + Steering consoles), Cadet Grey
- Natte Stone outside upholstery (+ helmsman seatbacks and seats)
- High comfort outside upholstery, Gallet
- Bow thruster
- 3 folding blades propeller
- 2nd arch with davits and instrument base
- 2nd arch with davits, solar panels + wind turbines
- White or black composite steering wheels
- Moorings lines, Mooring, Fenders
- Windlass control in cockpit with chain counter
- Shore freshwater supply
- Pump for deck washing
- Underwater light
- Windex Windvane
- Powered companionway door, foldable in the bottom of the cockpit + 2 Remote controls

## INTERIOR EQUIPMENT

- Interior woodwork: Alpi matt light oak
  - Upholstery: Leather, Ultraleather, Fabrics
  - Ivory or Oasis moleskin fitted carpet
  - Saloon / cabin cushioning: Meteor or Taupe
  - Ivory lacquered doors (Saloon - Galley)
  - Luxe folding saloon table on electric leg with up/down control
  - TV LED 22" folding + DVD and MP3 player in master cabin
  - TV LED 32" folding + Player Fusion (Bluetooth, USB, Dvd, MP3) in the saloon
  - Double berth in saloon
  - All-electric galley
  - 220V Microwave oven
  - 220 V Dishwasher - 6 people
  - Extractor hood
  - Sea water/fresh water foot pump
  - Freshwater filter
  - 220V Ice maker
  - Washer dryer 220 V
  - Safe
  - Electrically-operated saloon window blinds
  - Removable blind entrance door
  - Removable extra table
  - Extra water tank (330 litre / 87 US Gal)
  - Additional diesel tank (415 L / 110 US Gal in the saloon)
- 
- 7 kVA 220 V / 50 Hz Generator
  - Water maker 60 l/h / 16 US Gal/hour 12/220V
  - Heating (water system)
  - Chilled water air conditioning

## OTHER LAYOUT VERSIONS AVAILABLE

### OCCASIONAL CABIN

Port aft

- Access through the cockpit locker - Gas strut opening
- 1 Single berth
- 1 Opening porthole
- 1 hinged plexiglass panel in the cockpit side